

GT-M

range (Long Service Life) utilizes thick grids of modern technology so as to guarantee the design life up to 15 years. Advanced micro porous absorbent glass mat (AGM) separator, minimizing diffusion of oxygen into the separator, reduces float charge current which suppresses the corrosion rate of the positive grid, and extends the life of the battery.

Applications

- Electric Car & Scooter
- Toys and Spot Light
- Photovoltaic Solar System
- Marine Application
- UPS
- Toy

General Features

- Ideal for cyclic uses
- Good tolerance to higher temperature applications.
- ABS containers and covers (UL94HB, UL94V-0) optional.
- Safety valve installation for explosion proof.
- Higher safety & reliable construction.
- Extra durability and deep cycle ability for heavy demand applications.
- Low self discharge characteristic.
- Good tolerance to higher temperature applications.

Construction

- ComponentRaw material
- PositiveLead dioxide
- NegativeLead
- ContainerABS
- CoverABS
- SealantEpoxy Resin
- Safety valveEPDR
- TerminalLead
- SeparatorAGM
- Electrolytesulfuric acid thixotropic Gel

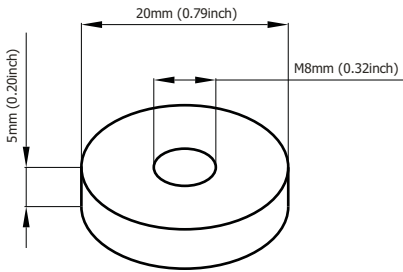

Standard Terminal Dimensions
(Optional terminal please check terminal information page)

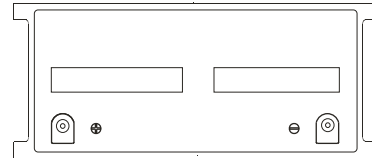
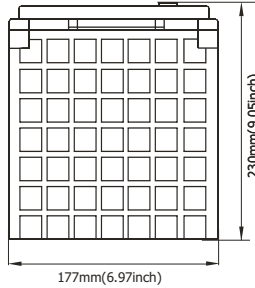
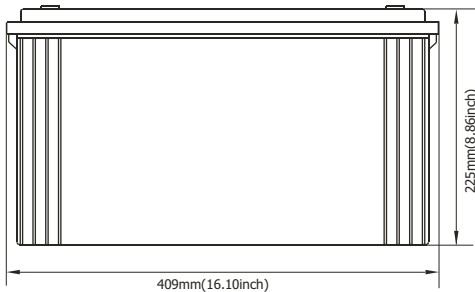

Battery Model	GT6-200M			
Designed Life	10-12 Years (Floating)			
Capacity(25C)	10HR(22.0A,1.80V)	8HR(25A,1.75V)	1HR(132A,1.75V)	Rated 15-min Capacity watts per cell to 1.67 VPC
	220Ah	200Ah	132Ah	688W
Dimensions	Length	Width	Height	Total Height
	409mm(16.10inch)	177mm(6.97inch)	225mm(8.86inch)	230mm(9.05inch)
Approx. Weight	39.5Kg (86.9 lbs)			
Internal Resistance	Full charged at 25°C: 0.000333 Ohm			
Self Discharge	3% of capacity declined per month at (25C)			
Capacity Affected by Temp.(20HR)	40C	25C	0C	-15C
	105%	100%	85%	68%
Charge Voltage(25C)	Cycle use		Float use	
	7.2-7.5V(-15mV/°C), max. Current: 25A		6.7-6.9V(-10mV/°C)	

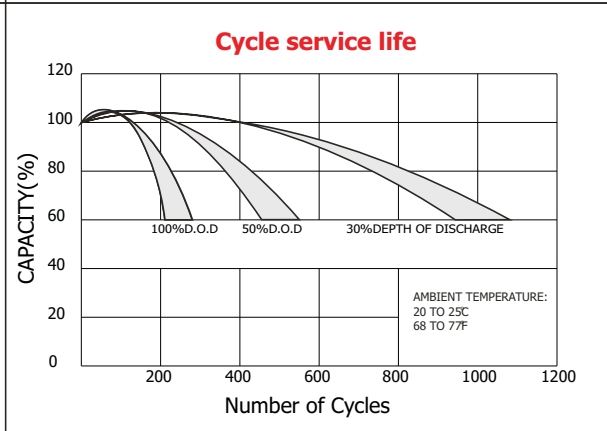
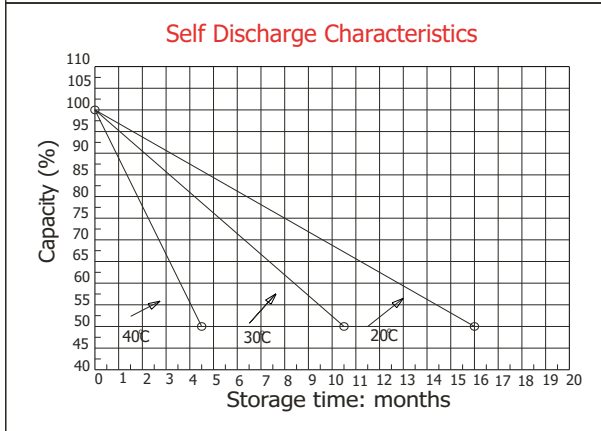
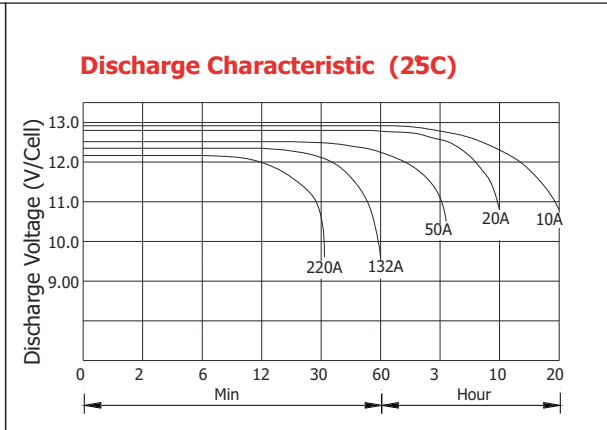
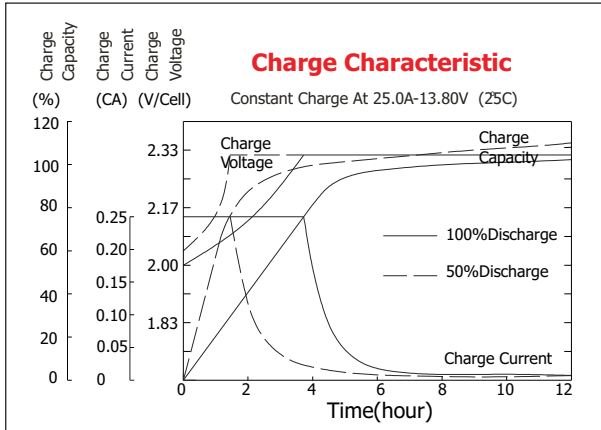

Constant current discharge ratings-amperes at 25C

F. VPC/Time	1MIN	5MIN	10MIN	15MIN	30MIN	1HR	3HR	5HR	8HR	10HR	20HR
1. 67V	1052	691	498	386	244	148	64.1	40.9	26.9	22.0	11.7
1. 70V	966	661	480	380	241	146	62.7	40.3	26.5	21.4	11.5
1. 75V	823	620	462	370	236	142	60.7	39.4	25.8	21.1	11.1
1. 80V	675	558	437	352	226	137	58.8	38.1	25.0	20.5	10.7
1. 85V	530	460	376	311	208	128	55.1	35.9	23.8	19.5	10.3
1. 90V	384	347	301	260	179	114	49.6	32.4	21.5	17.6	9.6
1. 95V	253	236	215	194	144	94	42.4	27.7	18.7	15.4	8.4

Constant power discharge ratings-watts at 25C

F. VPC/Time	1MIN	5MIN	10MIN	15MIN	30MIN	1HR	3HR	5HR	8HR	10HR	20HR
1. 67V	1757	1214	894	708	460	284	125	80.4	53.2	43.4	23.2
1. 70V	1642	1179	873	703	455	280	123	79.4	52.4	42.7	22.7
1. 75V	1441	1121	853	691	449	275	119	77.9	51.3	41.9	22.0
1. 80V	1216	1029	818	664	433	267	116	75.9	49.8	40.8	21.2
1. 85V	982	863	715	597	402	250	109	71.8	47.6	39.0	20.5
1. 90V	732	664	582	506	353	223	98	65.6	43.6	35.7	19.5
1. 95V	493	462	422	382	283	186	86	56.4	38.1	31.4	17.2