

HR(Hight Rate) range has been developed with high efficiency active materials to stimulate inside the battery with higher power output when the battery is discharged to a extent level. With high-density structure the inner resistance can be reduced to a relatively lower level, which will significantly improve the performance for high rate discharging when high power output service is needed.

Applications

Electric Car & Scooter	Marine Application
Toys and Spot Light	UPS
Photovoltaic Solar System	Toy

General Features

- Sealed and maintenance free operation.
- Non-Spillable construction design.
- ABS containers and covers(UL94HB, UL94V-0) optional.
- Safety valve installation for explosion proof.
- High quality and high reliability.
- Exceptional deep discharge recovery performance.
- Low self discharge characteristic.
- Flexibility design for multiple install positions.

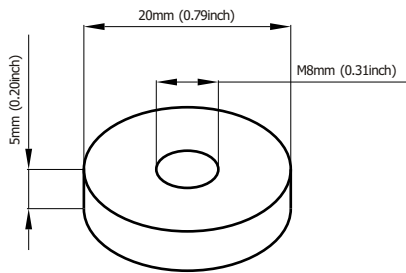

Standard Terminal Dimensions
(Optional terminal please check terminal information page)

Construction

ComponentRaw material	SealantHeat Sealed
PositiveLead dioxide	Safety valveEPDR
NegativeLead	TerminalCopper
ContainerABS	SeparatorFiber glass
CoverABS	ElectrolyteSulfuric acid

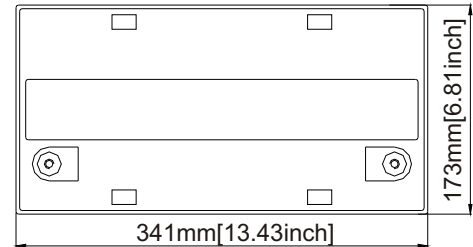
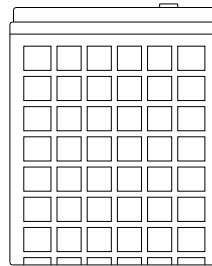

Battery Model	GT12-100HR (390W to 1.67V, 15min)			
Designed Floating Life	6-8 Years			
Capacity(25°C)	20HR(5.0A,1.75V)	10HR(9.8A,1.75V)	5HR(18.5A,1.75V)	1HR(72A,1.75V)
	100Ah	98Ah	92.5Ah	72Ah
Dimensions	Length	Width	Height	Total Height
	341mm(13.43inch)	173mm(6.81inch)	213mm(8.39inch)	241mm(9.49inch)
Approx. Weight	34Kg (74.8 lbs)			
Internal Resistance	Full charged at 25°C: 0.0055 Ohm			
Self Discharge	3% of capacity declined per month at (25°C)			
Capacity Affected by Temp.(20HR)	40°C	25°C	0°C	-15°C
	102%	100%	85%	65%
Charge Voltage(25°C)	Cycle use		Float use	
	14.4-15V(-30mV/ °C), max. Current: 25.0A		13.6-13.8V(-20mV/ °C)	

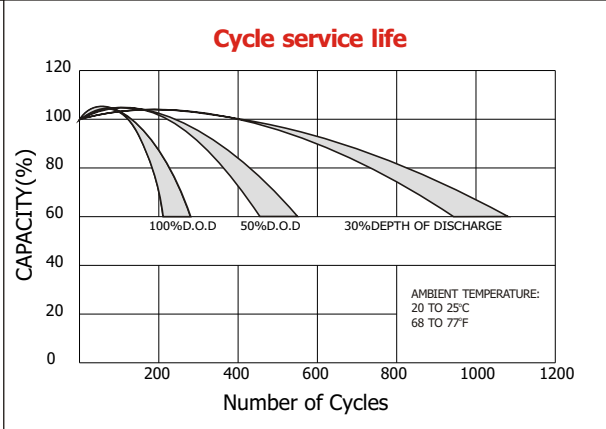
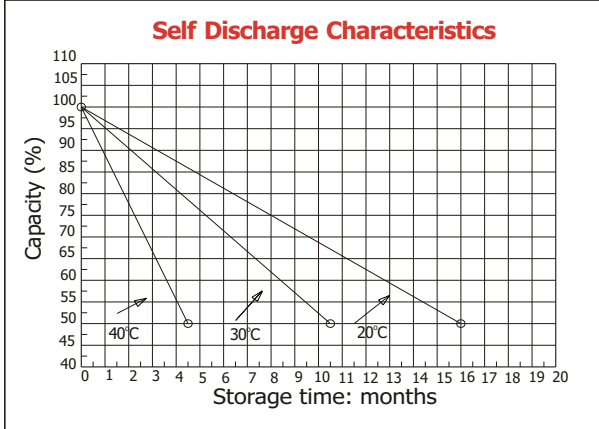
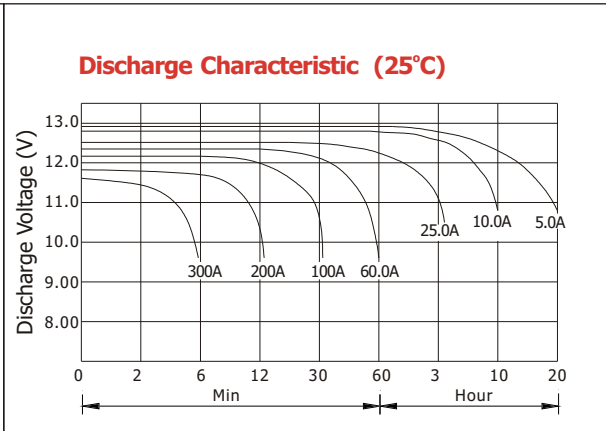
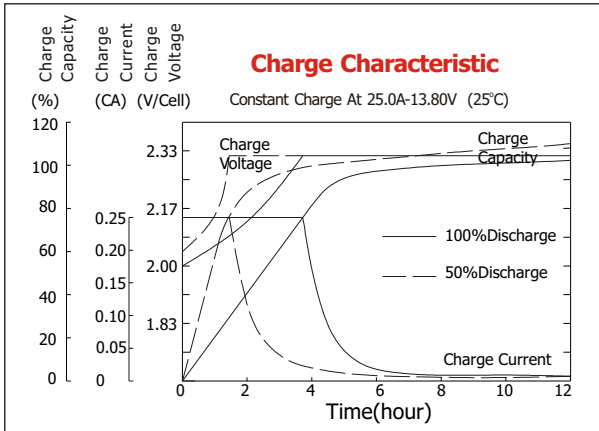

Constant current discharge ratings-amperes at 25°C

F. V/Time	5MIN	10MIN	15MIN	30MIN	1HR	3HR	5HR	10HR	20HR
1.60V	320	218	180	114.0	75.0	30.0	19.1	10.00	5.25
1.67V	290	215	173	113.0	74.0	29.7	18.9	9.90	5.20
1.70V	280	213	172	113.0	73.0	29.5	18.7	9.80	5.07
1.75V	275	212	170	112.0	72.0	29.0	18.5	9.80	5.00
1.80V	250	208	168	110.0	70.0	28.5	18.3	9.70	4.85
1.85V	228	200	164.0	103.0	68.0	27.9	18.0	9.70	4.80

Constant power discharge ratings-watts at 25°C

F. V/Time	5MIN	10MIN	15MIN	30MIN	1HR	3HR	5HR	10HR	20HR
1.60V	740	518	405	254	154.0	58.0	43.3	23.7	10.50
1.67V	714	505	397	253	153.0	57.7	43.2	23.3	10.50
1.70V	700	496	390	253	152.0	57.7	43.2	23.2	10.50
1.75V	662	475	378	245	152.0	57.5	43.0	23.2	10.50
1.80V	594	462	369	240	150.0	57.2	42.7	23.0	10.20
1.85V	560	441	358	230	146.0	56.3	41.5	22.7	9.90

