

AG(AGM and Gel) range uses the advanced GEL design, which combines the best features of both AGM and GEL construction into one battery line, and the purity fumed silica to form sulfuric acid thixotropic Gel, and fills the batteries with vacuum to ensure complete penetration of electrolyte through separators and plates pastes.

This range battery is designed to meet the requirement of frequent cyclic and high temperature application such as boardband, PVs etc.

Applications

Broadband
Electric Powered Vehicle
UPS
Photovoltaic & Solar System

Electric Powered Toy
Control System
Vacuum Cleaner
Medical Equipment
Golf Cars and Buggies
Wheel Chairs

General Features

Ideal for cyclic uses
Good tolerance to higher temperature applications.
ABS containers and covers(UL94HB, UL94V-0) optional.
Safety valve installation for explosion proof.
Higher safety & reliable construction.
Extra durability and deep cycle ability for heavy demand applications.
Low self discharge characteristic.
Good tolerance to higher temperature applications.

Construction

ComponentRaw material	SealantHeat Sealed
PositiveLead dioxide	Safety valveEPDR
NegativeLead	TerminalCopper
ContainerABS	SeparatorAGM
CoverABS	Electrolytesulfuric acid thixotropic Gel

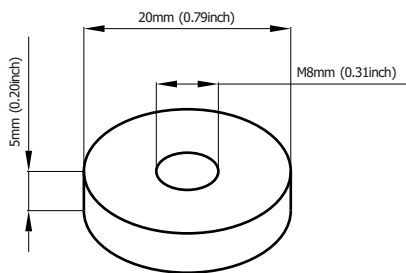

Standard Terminal Dimensions
(Optional terminal please check terminal information page)

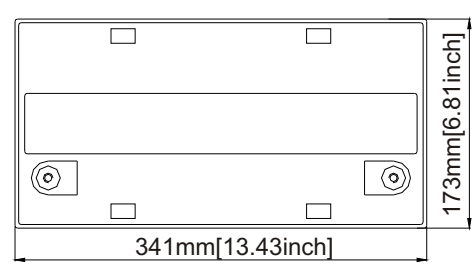
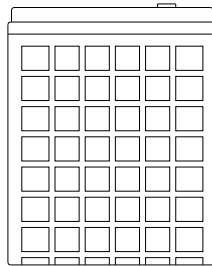

Battery Model	GT12-100AG-2 (390W to 1.67V, 15min)			
Designed Floating Life	8-10 Years			
Capacity(25°C)	20HR(5.0A,1.75V)	10HR(9.8A,1.75V)	5HR(18.5A,1.75V)	1HR(72A,1.75V)
	100Ah	98Ah	92.5Ah	72Ah
Dimensions	Length	Width	Height	Total Height
	341mm(13.43inch)	173mm(6.81inch)	213mm(8.39inch)	241mm(9.49inch)
Approx. Weight	34Kg (74.8 lbs)			
Internal Resistance	Full charged at 25°C: 0.0055 Ohm			
Self Discharge	3% of capacity declined per month at (25°C)			
Capacity Affected by Temp.(20HR)	40°C	25°C	0°C	-15°C
	102%	100%	85%	65%
Charge Voltage(25°C)	Cycle use		Float use	
	14.4-15V(-30mV/ °C), max. Current: 25.0A		13.6-13.8V(-20mV/ °C)	

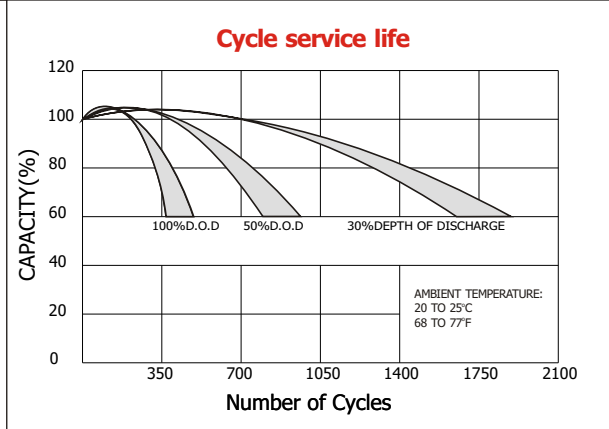
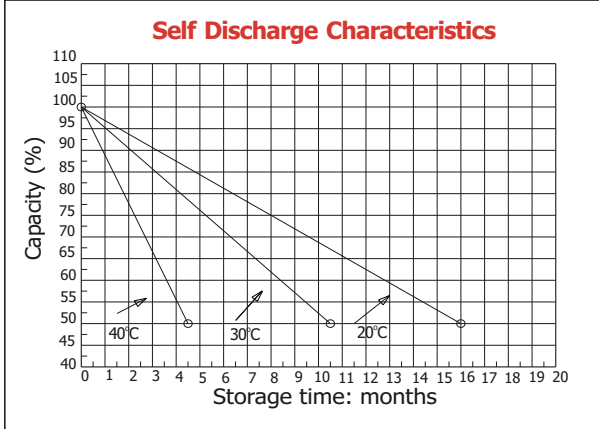
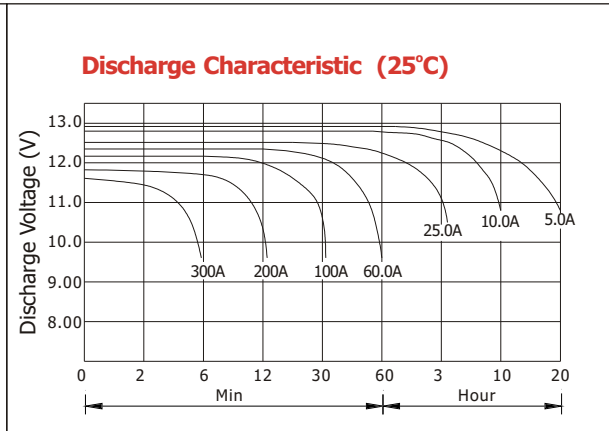
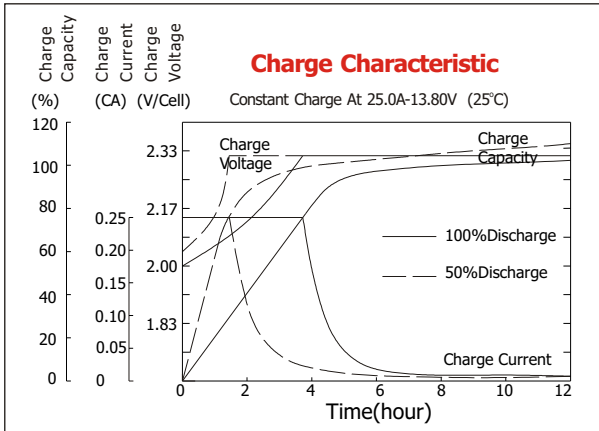

Constant current discharge ratings-amperes at 25°C

F. V/Time	5MIN	10MIN	15MIN	30MIN	1HR	3HR	5HR	10HR	20HR
1.60V	320	218	180	114.0	75.0	30.0	19.1	10.00	5.25
1.67V	290	215	173	113.0	74.0	29.7	18.9	9.90	5.20
1.70V	280	213	172	113.0	73.0	29.5	18.7	9.80	5.07
1.75V	275	212	170	112.0	72.0	29.0	18.5	9.80	5.00
1.80V	250	208	168	110.0	70.0	28.5	18.3	9.70	4.85
1.85V	228	200	164.0	103.0	68.0	27.9	18.0	9.70	4.80

Constant power discharge ratings-watts at 25°C

F. V/Time	5MIN	10MIN	15MIN	30MIN	1HR	3HR	5HR	10HR	20HR
1.60V	740	518	405	254	154.0	58.0	43.3	23.7	10.50
1.67V	714	505	397	253	153.0	57.7	43.2	23.3	10.50
1.70V	700	496	390	253	152.0	57.7	43.2	23.2	10.50
1.75V	662	475	378	245	152.0	57.5	43.0	23.2	10.50
1.80V	594	462	369	240	150.0	57.2	42.7	23.0	10.20
1.85V	560	441	358	230	146.0	56.3	41.5	22.7	9.90

